

# Dupixent® (dupilumab injection) 200 mg Pre-filled Pen

## Instructions for Use

Read the Instructions for Use before using the Dupixent Pre-filled Pen. Do not inject yourself or someone else until you have been shown how to inject Dupixent. Your healthcare provider can show you or your caregiver how to prepare and inject a dose of Dupixent before you try to do it yourself for the first time. The Dupixent Pre-filled Pen is only for use in adult, adolescent and pediatric patients aged 2 years of age and older. In children less than 12 years of age, Dupixent should be given by a caregiver. In adolescents 12 years of age and older, it is recommended that Dupixent be administered by or under supervision of an adult. Keep these instructions for use. Call your healthcare provider if you have any questions.

This device is a Single dose (single-use) Pre-filled Pen. It contains 200 mg of Dupixent for injection under the skin (subcutaneous injection).

**Keep these instructions for future use. If you have any further questions, you should ask your healthcare professional or call 1-800-265-7927.**

The parts of the Dupixent Pre-filled Pen are shown in this picture.

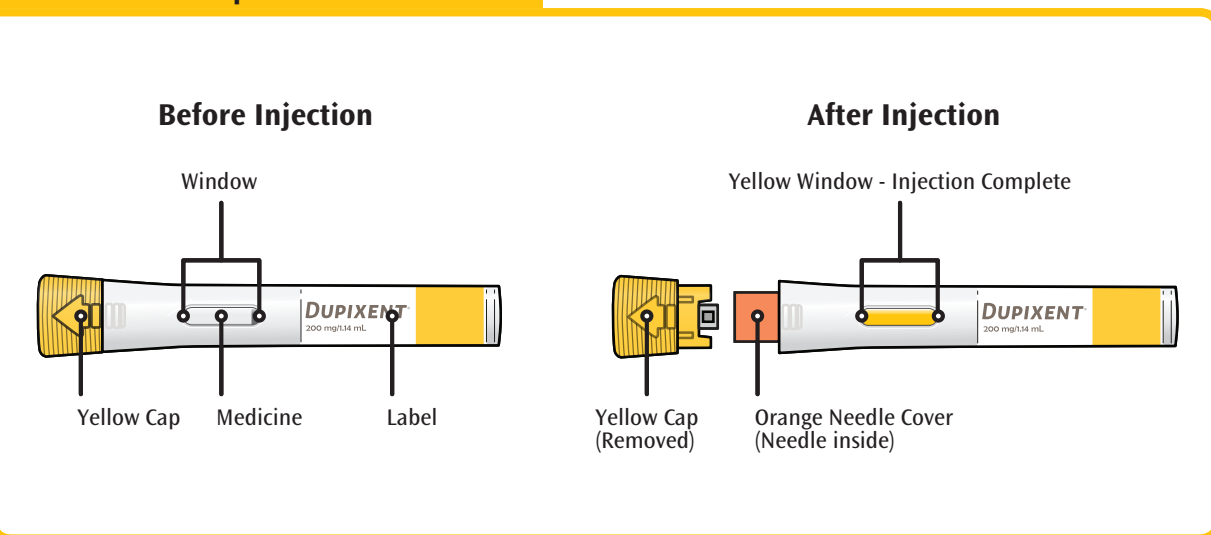

### Important Information:

- Read all of the instructions carefully before using the Pre-filled Pen.
- Ask your healthcare provider how often you will need to inject the medicine.
- In children 12 years of age and older, it is recommended that Dupixent be administered by or under supervision of an adult.
- In children 2 years to less than 12 years of age, Dupixent should be given by a caregiver.
- Choose a different injection site for each injection.
- **Do not** use the Pre-filled Pen if it has been damaged.
- **Do not** use the Pre-filled Pen if the Yellow Cap is missing or not securely attached.
- **Do not** press or touch the Orange Needle Cover with your fingers.
- **Do not** inject through clothes.
- **Do not** remove the Yellow Cap until just before you give the injection.
- **Do not** try to put the Yellow Cap back on the Pre-filled Pen.
- Throw away (dispose of) the Pre-filled Pen right away after use. See "Step D: Dispose" below.
- **Do not** re-use a Pre-filled Pen.

### How should I store Dupixent?

- Keep the Pre-filled Pen(s) and all medicines out of the reach of children.
- Store unused Pre-filled Pens in the refrigerator between 2°C and 8°C (36°F and 46°F).
- Store Pre-filled Pens in the original carton to protect it from light.
- **Do not** keep Pre-filled Pens at room temperature (less than 25°C (77°F)) for more than 14 days. Throw away (dispose) any Pre-filled Pens that have been left at room temperature for more than 14 days.
- **Do not** shake the Pre-filled Pen at any time.
- **Do not** heat the Pre-filled Pen.
- **Do not** freeze the Pre-filled Pen.
- **Do not** put the Pre-filled Pen into direct sunlight.

## A Prepare

### A1 Gather supplies

Ensure you have the following:

- the Dupixent Pre-filled Pen
- 1 alcohol wipe\*
- 1 cotton ball or gauze\*
- a sharps (puncture resistant) disposal container\* (See Step D)

\* Items not included in the carton.

### A2 Look at the Label



- Confirm that you have the correct product and dose.

### A3 Check Expiration Date



- Check the expiration date.
- **Do not use the Pre-filled Pen if the expiration date has passed.**

### A4 Check the Medicine

Look at the medicine through the window on the Pre-filled Pen: Check to ensure the liquid is clear and colorless to pale yellow. *Note: You may see an air bubble; this is normal.*

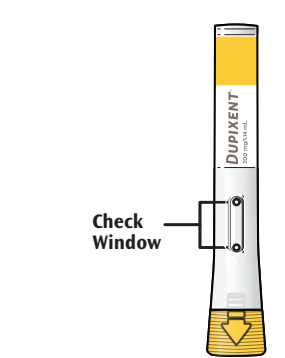

- **Do not use the Pre-filled Pen if the liquid is discolored or cloudy, or if it contains visible flakes or particles.**
- **Do not use the Pre-filled Pen if the window is yellow.**

### A5 Wait 30 minutes

Place the Pre-filled Pen on a flat surface and allow it to warm to room temperature (less than 25°C (77°F)) for at least 30 minutes.

- **Do not heat the Pre-filled Pen.**
- **Do not put the Pre-filled Pen into direct sunlight.**
- **Do not keep Dupixent at room temperature for more than 14 days. Dispose (throw away) any Dupixent Pens that have been left at room temperature for longer than 14 days.**

## B Choose your injection site

### B1 Recommended injection sites are:

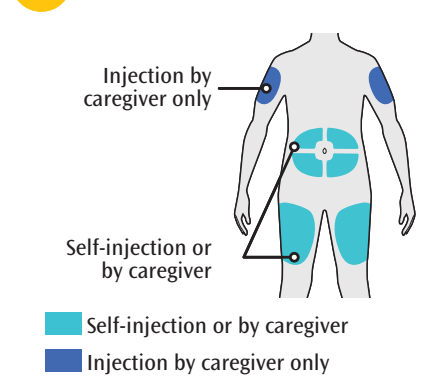

- **Thigh**
  - **Abdomen** except for the 5 cm (2 inches) around your belly button (navel).
  - **Upper Arm** if a caregiver gives your dose, they can also use the outer area of the upper arm.
- Choose a different injection site for each Dupixent injection.
- **Do not inject through clothes.**
  - **Do not inject into skin that is tender, damaged, bruised or scarred.**

### B2 Wash your hands

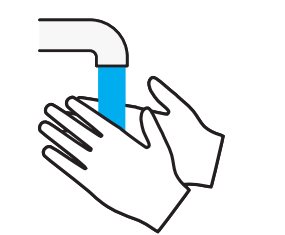

### B3 Prepare the injection site

- Clean the injection site with an alcohol wipe.
- Let your skin dry before injecting.
- **Do not touch the injection site again or blow on it before the injection.**

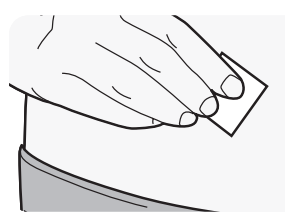

## C Give injection

### C1 Remove Yellow Cap

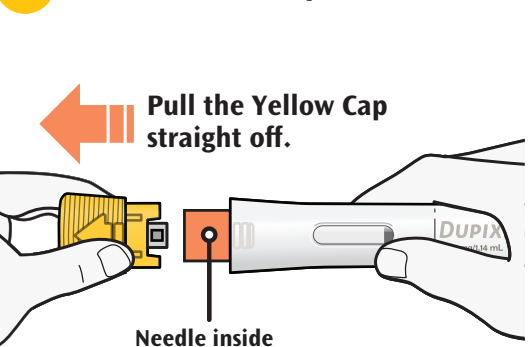

- **Pull the Yellow Cap straight off.**
- **Do not** twist the Yellow Cap off.
- **Do not** remove the Yellow Cap until you are ready to inject.
- **Do not** press or touch the Orange Needle Cover with your fingers. The Needle is inside.
- **Do not put the Yellow Cap back on the Pre-filled Pen after you have removed it.**

### C2 Pinch Skin and Place

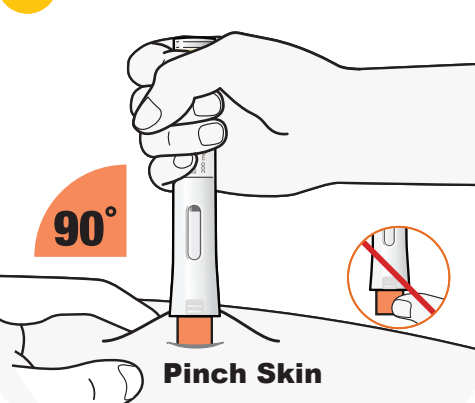

- For pediatric patients 2 years to less than 12 years old, pinch the skin before and during the injection.
- Pinching of the skin is not needed for adult and adolescent patients aged 12 years and older.
- When placing the Orange Needle Cover on your skin, hold the Pre-filled Pen so that you can see the Window.

- Place the Orange Needle Cover on your skin at approximately a 90-degree angle.
- **Do not press or touch the Orange Needle Cover with your fingers; the Needle is inside.**

### C3 Press down

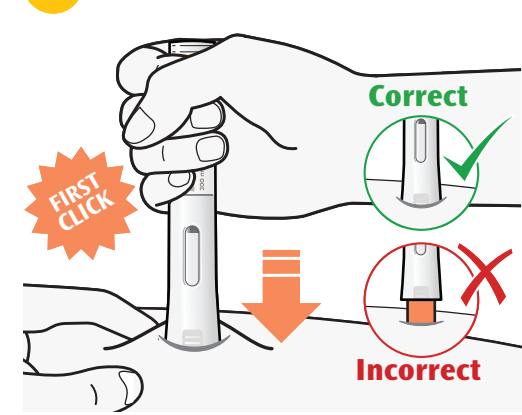

- Press and hold the Pre-filled Pen firmly against your skin until you cannot see the Orange Needle Cover.
- There will be a "click" when the injection starts.
- The window will start to turn yellow.
- The injection can take up to 15 seconds.
- Pinching of skin is not needed for adults and children aged 12 years and older.

### C4 Hold firmly

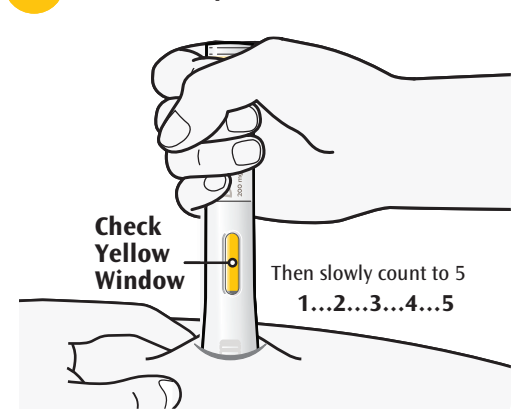

- Keep holding the Pre-filled Pen firmly against your skin.
- You may hear a second click.
- Check that the entire window has turned to yellow.
- Then slowly count to 5.
- Then lift the pen up off the skin, your injection is complete.

- If the window does not turn completely yellow, remove the pen and call your healthcare provider.
- **Do not give yourself a second dose unless instructed by your healthcare provider.**
- Pinching of skin is not needed for adults and children aged 12 years and older.

### C5 Remove

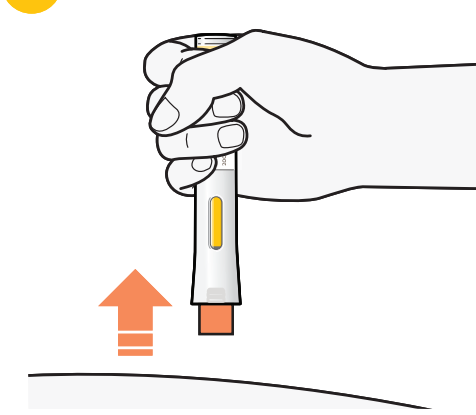

- After you have completed your injection, pull straight up to remove Pre-filled Pen from the skin.
- If you see any blood at the site, lightly dab the site with a clean cotton ball or gauze pad.
- **Do not rub your skin after the injection.**

## D Dispose

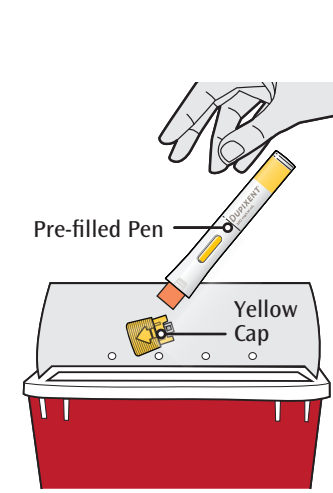

- Dispose (throw away) your used Dupixent Pre-filled Pens, (Needle inside), and Yellow Caps in a puncture resistant (sharps disposal) container right away after use.
- **Do not** dispose (throw away) the used Pre-filled Pens (Needle inside) or Yellow Caps in your household trash.
- **Do not put the Yellow Cap back on the Pre-filled Pens.**

This leaflet was prepared by sanofi-aventis Canada Inc. Dupixent® is a registered trademark of Sanofi Biotechnology, SA. Last Revised: March 14, 2024. Manufactured by sanofi-aventis Canada Inc., Toronto, Ontario, Canada M2R 3T4. Questions: 1-800-265-7927. FXXXXXXA

